

| | | | | | | | | | |
|---|---|----|-------|-------|------|--------|-----|---------|----------|
| | Pedestal | 19 | 4.00 | 0.60 | 0.60 | 27.36 | | | |
| | column up to plinth (0.30+0.40=0.70) | 13 | 2.00 | 0.70 | 1.55 | 28.21 | | | |
| | | 6 | 4.00 | 0.30 | 1.55 | 11.16 | | | |
| | | | | | | 120.13 | Sqm | 320.40 | 38489.00 |
| 6 | [S.O.R.P/AMD 02.12.2015 & I/2.28.2] | | | | | | | | |
| | Supplying and filling in plinth with soil (other than B.C. Soil) Having MDD not less than 1.85 t/m3 under floor including watering, ramming, compacting (minimum compaction 95% of MDD) in layer not exceeding 15 cm in depth and dressing complete. | | | | | | | | |
| | Qty same as Item No. 2 | | | | | 129.45 | | | |
| | Deduction Qty of Item No.3 | | | | | -10.62 | | | |
| | Deduction Qty of Item No.5 | | | | | -24.21 | | | |
| | under Floor | 1 | 15.70 | 12.10 | 0.40 | 75.99 | | | |
| | | | | | | 170.61 | Cum | 225.00 | 38387.00 |
| 7 | [S.O.R.P/65 & I/5.2.1] | | | | | | | | |
| | Providing and laying in position specified grade of reinforced cement concrete (with 20mm nominal size graded stone aggregate) excluding the cost of centering, shuttering, finishing and reinforcement - All work up to plinth level :M 20 –Grade Concrete | | | | | | | | |
| | Column Upto Plinth | 13 | 0.30 | 0.40 | 1.20 | 1.87 | | | |
| | | 6 | 0.30 | 0.30 | 1.20 | 0.65 | | | |
| | Beam | 2 | 11.25 | 0.30 | 0.40 | 2.70 | | | |
| | | 3 | 14.80 | 0.30 | 0.40 | 5.33 | | | |
| | | 2 | 8.00 | 0.30 | 0.30 | 1.44 | | | |
| | | 1 | 8.00 | 0.30 | 0.40 | 0.96 | | | |
| | | 2 | 2.70 | 0.30 | 0.30 | 0.49 | | | |
| | C.W. | 2 | 14.80 | 0.15 | 1.00 | 4.44 | | | |
| | | 2 | 11.25 | 0.15 | 1.00 | 3.38 | | | |
| | | | | | | 21.26 | Cum | 4681.80 | 99535.00 |
| 8 | [S.O.R.P/66 & I/5.9.1] | | | | | | | | |
| | Centering and shuttering including strutting, propping etc. and removal of form for :Foundations, footings, bases of columns, etc. for concrete up to plinth level. | | | | | | | | |
| | Column | 13 | 2.00 | 0.70 | 1.20 | 21.84 | | | |
| | | 6 | 2.00 | 0.60 | 1.20 | 8.64 | | | |
| | | | | | | 30.48 | Sqm | 156.60 | 4773.00 |
| | [S.O.R.P/66 & I/5.9.2] | | | | | | | | |
| | Walls (any thickness) including attached pilasters buttresses, plinth beams and string courses etc.up to plinth level. | | | | | | | | |
| | Beam | 2 | 2.00 | 11.25 | 0.30 | 13.50 | | | |
| | | 2 | 1.00 | 11.25 | 0.15 | 3.38 | | | |
| | | 3 | 2.00 | 14.80 | 0.30 | 26.64 | | | |
| | | 3 | 1.00 | 14.80 | 0.15 | 6.66 | | | |
| | | 2 | 2.00 | 8.00 | 0.30 | 9.60 | | | |
| | | 2 | 1.00 | 8.00 | 0.30 | 4.80 | | | |
| | | 1 | 2.00 | 8.00 | 0.40 | 6.40 | | | |
| | | 1 | 1.00 | 8.00 | 0.30 | 2.40 | | | |
| | | 2 | 2.00 | 2.70 | 0.30 | 3.24 | | | |
| | | 2 | 1.00 | 2.70 | 0.30 | 1.62 | | | |
| | C.W. | 2 | 2.00 | 14.80 | 1.00 | 59.20 | | | |
| | | 2 | 2.00 | 11.25 | 1.00 | 45.00 | | | |
| | | | | | | 182.44 | Sqm | 240.30 | 43840.00 |
| | [S.O.R.P/66 & I/5.9.3] | | | | | | | | |
| | Centering and shuttering including strutting, propping etc. and removal of form for :Suspended floors, roofs, landings, balconies and access platform. | | | | | | | | |
| | Front Portion | 1 | 16.85 | 4.30 | | 72.46 | | | |

| | | | | | | | | | |
|---|---|----|-------|-------|------|--------|-----|--------|----------|
| | Godown | 1 | 17.00 | 9.70 | | 164.90 | | | |
| | Stair | 9 | 2.00 | 0.12 | | 2.16 | | | |
| | Beam | 4 | 2.00 | 2.65 | 0.25 | 5.30 | | | |
| | | 1 | 2.00 | 14.20 | 0.25 | 7.10 | | | |
| | Godown | 3 | 2.00 | 8.40 | 0.25 | 12.60 | | | |
| | | 2 | 2.00 | 8.40 | 0.45 | 15.12 | | | |
| | | 2 | 2.00 | 14.50 | 0.25 | 14.50 | | | |
| | Bottom | 4 | 1.00 | 2.65 | 0.30 | 3.18 | | | |
| | | 1 | 1.00 | 14.20 | 0.30 | 4.26 | | | |
| | | 3 | 1.00 | 8.40 | 0.30 | 7.56 | | | |
| | | 2 | 1.00 | 8.40 | 0.30 | 5.04 | | | |
| | | 2 | 1.00 | 14.50 | 0.30 | 8.70 | | | |
| | First Floor | 1 | 1.00 | 9.60 | 5.20 | 49.92 | | | |
| | Beam | 2 | 5.20 | 2.00 | 0.30 | 6.24 | | | |
| | | 1 | 9.60 | 2.00 | 0.30 | 5.76 | | | |
| | | 1 | 9.60 | 2.00 | 0.50 | 9.60 | | | |
| | Bottom | 1 | 2.00 | 5.20 | 0.30 | 3.12 | | | |
| | | 1 | 1.00 | 9.60 | 0.30 | 2.88 | | | |
| | | 1 | 1.00 | 9.60 | 0.30 | 2.88 | | | |
| | | | | | | 403.28 | Sqm | 237.60 | 95819.00 |
| | [S.O.R.P/66 & I/5.9.5] | | | | | | | | |
| | Centering and shuttering including strutting, propping etc. and removal of form for :Lintels, beams, girders, bressumers and cantilevers. | | | | | | | | |
| | Lintel R/s | 1 | 3.00 | 7.20 | 0.30 | 6.48 | | | |
| | Room | 2 | 3.00 | 2.65 | 0.20 | 3.18 | | | |
| | | 1 | 3.00 | 3.70 | 0.20 | 2.22 | | | |
| | Chajja | 1 | 3.00 | 1.74 | 0.62 | 3.24 | | | |
| | Godown lintel | 2 | 3.00 | 11.25 | 0.30 | 20.25 | | | |
| | Ring | 3 | 3.00 | 14.80 | 0.30 | 39.96 | | | |
| | Lintel | 2 | 2.00 | 9.20 | 0.20 | 7.36 | | | |
| | | 3 | 2.00 | 4.70 | 0.20 | 5.64 | | | |
| | Chajja | 1 | 5.00 | 1.74 | 0.62 | 5.39 | | | |
| | | | | | | 93.72 | Sqm | 204.30 | 19146.00 |
| | [S.O.R.P/66 & I/5.9.6] | | | | | | | | |
| | Centering and shuttering including strutting, propping etc. and removal of form for :Columns, Pillars, Piers, Abutments, Posts and Struts. | | | | | | | | |
| | Column | 13 | 2.00 | 0.70 | 4.30 | 78.26 | | | |
| | | 6 | 4.00 | 0.30 | 3.30 | 23.76 | | | |
| | First Floor Column | 5 | 2.00 | 0.70 | 3.30 | 23.10 | | | |
| | | | | | | 125.12 | Sqm | 320.40 | 40088.00 |
| 9 | [S.O.R.P/AMD 02.12.2015 & I/2.28.1] | | | | | | | | |
| | Supplying and filling in plinth with hard muram/hard copra having MDD not less than 2.0tm ³ under floors including watering ramming and compacting (minimum compaction 95% of MDD) in layers exceeding 20cm in thickness and dressing complete. (Note- Maximum thickness of this layer to be provided shall be 30cm) | | | | | | | | |
| | | 1 | 15.70 | 12.10 | 0.30 | 56.99 | | | |
| | | 1 | 16.00 | 2.00 | 0.30 | 9.60 | | | |
| | (16+2x12.40) | 1 | 14.80 | 1.00 | 0.30 | 4.44 | | | |
| | | | | | | 71.03 | Cum | 270.00 | 19178.00 |

| | | | | | | | | | |
|----|---|----|-------|-------|------|-------|-----|---------|-----------|
| 10 | [S.O.R.P/26 & I/2.27] | | | | | | | | |
| | Supplying and filling in plinth with crusher stone dust / coarse sand under floors including, watering, ramming consolidating in layers not exceeding 20cm in depth and dressing complete | | | | | | | | |
| | | 1 | 15.40 | 11.80 | 0.20 | 36.34 | | | |
| | | | | | | 36.34 | Cum | 604.80 | 21978.00 |
| 11 | [S.O.R.P/45 & I/4.1.2.2] | | | | | | | | |
| | Providing and laying in position cement concrete of specified grade excluding the cost of centering and shuttering - All work up to plinth level : With 40mm nominal size graded stone aggregate. Nominal Mix - 1 Cement : 3 sand : 6 graded stone aggregate (M 10) | | | | | | | | |
| | Footing | 13 | 1.80 | 1.80 | 0.15 | 6.32 | | | |
| | | 6 | 1.50 | 1.50 | 0.15 | 2.03 | | | |
| | Drain | 2 | 12.40 | 0.40 | 0.10 | 0.99 | | | |
| | | 2 | 16.00 | 0.40 | 0.10 | 1.28 | | | |
| | Under floor | 1 | 15.40 | 11.80 | 0.15 | 27.26 | | | |
| | | 1 | 16.00 | 2.00 | 0.15 | 4.80 | | | |
| | (16+2x12.40) | 1 | 14.80 | 1.00 | 0.10 | 1.48 | | | |
| | | | | | | 44.16 | Cum | 3427.20 | 151345.00 |
| 12 | [S.O.R.P/45 & I/4.1.1.2] | | | | | | | | |
| | Providing and laying in position cement concrete of specified grade excluding the cost of centering and shuttering - All work up to plinth level : M 20 – Grade concrete | | | | | | | | |
| | M-20 | 1 | 16.00 | 2.00 | 0.20 | 6.40 | | | |
| | | | | | | 6.40 | Cum | 4439.70 | 28414.00 |
| 13 | [S.O.R.P/65 & I/5.2.1] | | | | | | | | |
| | Reinforced cement concrete work (with 20mm nominal size graded stone aggregate) in walls (any thickness), including attached pilasters, buttresses, plinth and string courses, fillets, columns, pillars, posts and struts etc. above plinth level and up to floor two level excluding cost of centering, shuttering, finishing and reinforcement : | | | | | | | | |
| | Column | 13 | 0.30 | 0.40 | 4.30 | 6.71 | | | |
| | | 6 | 0.30 | 0.30 | 3.30 | 1.78 | | | |
| | First Floor Column | 5 | 0.30 | 0.40 | 3.30 | 1.98 | | | |
| | | | | | | 10.47 | cum | 4681.80 | 49018.00 |
| 14 | [S.O.R.P/65 & I/5.3.1] | | | | | | | | |
| | Reinforced cement concrete work (with 20mm nominal size graded stone aggregate) in beams, suspended floors, roofs having slope of any degree landings, balconies, shelves, chajjas, lintels, bands, plain window sills, staircases and spiral stair cases above plinth level and up to floor two level excluding the cost of centering, shuttering, finishing and reinforcement in concrete grade. M 20 –Grade Concrete | | | | | | | | |
| | Lintel R/s | 1 | 7.20 | 0.30 | 0.30 | 0.65 | | | |
| | Room | 2 | 2.65 | 0.20 | 0.20 | 0.21 | | | |
| | | 1 | 3.70 | 0.20 | 0.20 | 0.15 | | | |
| | Chajja | 3 | 1.50 | 0.50 | 0.12 | 0.27 | | | |
| | Godown lintel | 2 | 11.25 | 0.30 | 0.30 | 2.03 | | | |

| | | | | | | | | | |
|----|--|----|-------|-------|------|--------|-----|---------|-----------|
| | | 3 | 14.80 | 0.30 | 0.30 | 4.00 | | | |
| | Lintel | 3 | 0.20 | 0.20 | 3.70 | 0.44 | | | |
| | | 2 | 0.20 | 0.20 | 8.20 | 0.66 | | | |
| | Chajja | 5 | 1.50 | 0.50 | 0.12 | 0.45 | | | |
| | Slab | 1 | 16.70 | 3.20 | 0.15 | 8.02 | | | |
| | | 1 | 16.70 | 9.20 | 0.15 | 23.05 | | | |
| | Stair | 1 | 9.00 | 1.20 | 0.15 | 1.62 | | | |
| | Beam | 4 | 2.65 | 0.30 | 0.40 | 1.27 | | | |
| | | 1 | 14.20 | 0.30 | 0.40 | 1.70 | | | |
| | Godown | 3 | 8.40 | 0.30 | 0.40 | 3.02 | | | |
| | | 2 | 8.40 | 0.30 | 0.60 | 3.02 | | | |
| | | 2 | 14.50 | 0.30 | 0.40 | 3.48 | | | |
| | First Floor | 1 | 9.60 | 5.20 | 0.12 | 5.99 | | | |
| | Beam | 2 | 5.20 | 0.30 | 0.30 | 0.94 | | | |
| | | 1 | 9.60 | 0.30 | 0.50 | 1.44 | | | |
| | | | | | | 62.41 | Cum | 4755.60 | 296796.00 |
| 15 | [S.O.R.P/87 & I/6.7.3.2] | | | | | | | | |
| | Brick work with fly ash lime bricks (FALG Bricks) conforming to IS:12894-2002, in super structure above plinth level up to floor II level in : Cement mortar 1:6 (1 cement : 6 sand) | | | | | | | | |
| | Stair Case | 1 | 2.65 | 0.20 | 2.10 | 1.11 | | | |
| | | 2 | 14.80 | 0.30 | 3.70 | 32.86 | | | |
| | Godown | 1 | 14.20 | 0.20 | 2.70 | 7.67 | | | |
| | | 3 | 8.40 | 0.30 | 3.70 | 27.97 | | | |
| | Room | 2 | 2.65 | 0.20 | 2.50 | 2.65 | | | |
| | | 1 | 3.70 | 0.20 | 2.50 | 1.85 | | | |
| | (20x1/2) | 10 | 0.20 | 0.25 | 1.20 | 0.60 | | | |
| | Deduction Window | -4 | 1.20 | 0.90 | 0.20 | -0.86 | | | |
| | Deduction Door | -1 | 1.20 | 2.10 | 0.20 | -0.50 | | | |
| | R/s | -2 | 2.40 | 2.70 | 0.30 | -3.89 | | | |
| | Ventilator | -8 | 1.00 | 0.50 | 0.30 | -1.20 | | | |
| | Gate | -1 | 3.00 | 3.00 | 0.20 | -1.80 | | | |
| | First Floor Hall | 1 | 8.00 | 0.20 | 3.00 | 4.80 | | | |
| | | 1 | 8.00 | 0.20 | 2.80 | 4.48 | | | |
| | | 2 | 3.70 | 0.20 | 3.00 | 4.44 | | | |
| | | 1 | 3.85 | 0.20 | 3.30 | 2.54 | | | |
| | Deduction Window | -5 | 1.20 | 0.90 | 0.20 | -1.08 | | | |
| | Deduction Door | -2 | 1.00 | 2.10 | 0.20 | -0.84 | | | |
| | Parapet (16+12.40) | 2 | 1.00 | 28.40 | 0.20 | 11.36 | | | |
| | | | | | | 92.16 | Cum | 3990.00 | 367718.00 |
| 16 | [S.O.R.P/244 & I/13.1.2] | | | | | | | | |
| | 12 mm cement plaster of mix : 1:6 (1 cement : 6 sand) | | | | | | | | |
| | Room | 1 | 2.65 | 2.10 | | 5.57 | | | |
| | | 2 | 2.65 | 2.50 | | 13.25 | | | |
| | | 1 | 3.70 | 2.50 | | 9.25 | | | |
| | Godown | 2 | 14.80 | 3.70 | | 109.52 | | | |
| | | 1 | 14.20 | 3.70 | | 52.54 | | | |
| | | 4 | 8.40 | 3.70 | | 124.32 | | | |
| | Deduction Window | -4 | 1.20 | 0.90 | | -4.32 | | | |
| | Deduction Door | -1 | 1.20 | 2.10 | | -2.52 | | | |
| | R/s | -2 | 2.40 | 2.70 | | -12.96 | | | |
| | Ventilator | -8 | 1.00 | 0.50 | | -4.00 | | | |
| | Gate | -1 | 3.00 | 3.00 | | -9.00 | | | |
| | First Floor | 1 | 8.00 | 3.00 | | 24.00 | | | |
| | | 1 | 8.00 | 2.80 | | 22.40 | | | |
| | | 2 | 3.70 | 3.00 | | 22.20 | | | |

| | | | | | | | | | |
|----|---|----|-------|-------|--|--------|-----|---------|----------|
| | | 1 | 3.85 | 3.30 | | 12.71 | | | |
| | Deduction Window | -5 | 1.20 | 0.90 | | -5.40 | | | |
| | Deduction Door | -2 | 1.00 | 2.10 | | -4.20 | | | |
| | | | | | | 353.36 | Sqm | 99.00 | 34982.00 |
| 17 | [S.O.R.P/244 & I/13.2.2] | | | | | | | | |
| | 15 mm cement plaster on the rough side of single or half brick wall of mix : 1:6 (1 cement : 6 sand) | | | | | | | | |
| | Room | 1 | 2.65 | 2.10 | | 5.57 | | | |
| | | 2 | 2.65 | 2.50 | | 13.25 | | | |
| | | 1 | 3.70 | 2.50 | | 9.25 | | | |
| | | 1 | 14.20 | 3.70 | | 52.54 | | | |
| | First Floor | 1 | 8.00 | 3.00 | | 24.00 | | | |
| | | 1 | 8.00 | 2.80 | | 22.40 | | | |
| | | 2 | 3.70 | 3.00 | | 22.20 | | | |
| | | 1 | 3.85 | 3.30 | | 12.71 | | | |
| | Deduction Window | -5 | 1.20 | 0.90 | | -5.40 | | | |
| | Deduction Door | -2 | 1.00 | 2.10 | | -4.20 | | | |
| | | | | | | 152.32 | Sqm | 115.20 | 17547.00 |
| 18 | [S.O.R.P/ 244 & I/13.8.1] | | | | | | | | |
| | 6 mm cement plaster of mix :1:3 (1 cement : 3 sand) | | | | | | | | |
| | Ceiling | 1 | 16.80 | 13.20 | | 221.76 | | | |
| | Ceiling | 1 | 4.60 | 9.20 | | 42.32 | | | |
| | | | | | | 264.08 | Sqm | 86.40 | 22816.00 |
| 19 | [S.O.R.P/178 & I/10.3] | | | | | | | | |
| | Providing and fixing in position collapsible steel shutters with vertical channels 20x10x2mm and braced with flat iron diagonals 20x5mm size with top and bottom rail of T-iron 40x40x6mm with 40mm dia steel pulleys complete with bolts, nuts, locking arrangement, stoppers,handles, including applying a priming coat of approved steel primer. Rate includes recess cutting in floor and making good the same wherever required. | | | | | | | | |
| | | 1 | 3.00 | 3.00 | | 9.00 | | | |
| | | | | | | 9.00 | Sqm | 3718.71 | 33468.00 |
| 20 | [S.O.R.P/178 & I/10.6.3] | | | | | | | | |
| | Supplying and fixing rolling shutters of approved make, made of required size M.S. laths interlocked together through their entire length and jointed together at the end by end locks mounted on specially designed pipe shaft with brackets, side guides and arrangements for inside and outside locking with push and pull operation complete including the cost of providing and fixing necessary 27.5cm long wire springs manufactured from high tensile steel wire of adequate strength conforming to I.S. 4454- part-1 and M.S. top cover of required thickness for rolling shutters.80x0.90 mm M.S. laths with 0.90 mm thick top cover. | | | | | | | | |
| | | 2 | 2.40 | 2.70 | | 12.96 | | | |
| | | | | | | 12.96 | Sqm | 1544.54 | 20017.00 |

| | | | | | | | | | |
|----|--|---|------|------|-------|--------|-----|--------|----------|
| 21 | [S.O.R.P/178 & I/10.2] | | | | | | | | |
| | Structural steel work riveted, bolted or welded in built up sections, trusses and framed work, including cutting, hoisting, fixing in position and applying a priming coat of approved steel primer all complete. | | | | | | | | |
| | Ventilator | 8 | 1.00 | 0.50 | 25.00 | 100.00 | | | |
| | | | | | | 100.00 | Kg | 61.83 | 6183.00 |
| 21 | [S.O.R.P/179 & I/10.10.1] | | | | | | | | |
| | Providing and fixing factory made ISI marked steel glazed doors, windows and ventilators side /top /centre hung with beading and all members such as F7D, F4B, K11 B and K12 B etc. complete of standard rolled steel sections, joints mitred and flash butt welded and sash bars tenoned and riveted, including providing and fixing of hinges, pivots, including priming coat of approved steel primer, but excluding the cost of other fittings, complete all as per approved design (sectional weight of only steel members shall be measured for payment). Fixing with 15x3 mm lugs 10 cm. long embedded in cement concrete block 15x10x10 cm of Cement Concrete 1:3:6 (1 Cement : 3 sand : 6 graded stone aggregate 20 mm nominal size). | | | | | | | | |
| | Window | 4 | 1.20 | 0.90 | 35.00 | 151.20 | | | |
| | | 8 | 1.00 | 0.50 | 27.00 | 108.00 | | | |
| | Window | 5 | 1.20 | 0.90 | 35.00 | 189.00 | | | |
| | | | | | | 448.20 | Kg | 96.17 | 43103.00 |
| 22 | [S.O.R.P/180 & I/10.13.2.1] | | | | | | | | |
| | Providing and fixing pressed steel door frames conforming to IS: 4351 manufactured from commercial mild steel sheet including hinges, jamb, lock jamb, bead and if required angle threshold of mild steel angle of section 50x25mm, or base ties of 1.60 mm pressed mild steel welded or rigidly fixed together by mechanical means, including M.S. pressed butt hinges, 2.5mm thick with mortar guards, lock strike-plate and shock absorbers as specified filling the frame with Cement Concrete 1:3:6 at site before fixing (cost of concrete to be paid separately) and applying a coat of approved steel primer after pre-treatment of the surface as directed by Engineer-in-charge. Profile C of 1.60mm thick single rebate of size 100mmx50mm Fixing with adjustable lugs with split end tail to each jamb. | | | | | | | | |
| | Door | 1 | 2.00 | 2.75 | | 5.50 | | | |
| | Door | 2 | 2.00 | 2.75 | | 11.00 | | | |
| | | | | | | 16.50 | Sqm | 388.26 | 6406.00 |

| | | | | | | | | | |
|----|--|----|-------|------|--|--------|-----|---------|----------|
| 23 | [S.O.R.P/135 & I/9.18.2] | | | | | | | | |
| | Providing and fixing ISI marked flush door shutters conforming to IS: 2202 (Part I) decorative type, core of block board construction with frame of 1st class hard wood and well matched teak 3 ply veneering with vertical grains or cross bands and face veneers on both faces of shutters of such as duro board, century or equivalent make.30 mm thick including ISI marked Stainless Steel butt hinges with necessary screws. | | | | | | | | |
| | Door Shutter | 1 | 1.20 | 2.10 | | 2.52 | | | |
| | | 2 | 1.20 | 2.10 | | 5.04 | | | |
| | | | | | | 7.56 | Sqm | 3294.00 | 24902.00 |
| 24 | [S.O.R.P/ 196 & I/11.2] | | | | | | | | |
| | 52 mm thick cement concrete flooring with concrete hardener topping, under layer 40 mm thick cement concrete 1:2:4 (1 cement : 2 sand : 4 graded stone aggregate 20 mm nominal size) and top layer 12 mm thick cement hardener consisting of mix 1:2 (1 cement hardener mix : 2 graded stone aggregate 6 mm nominal size) by volume, hardening compound mixed @ 2 litre per 50Kg of cement or as per manufacturers specifications. This includes cost of cement slurry, but excluding the cost of nosing of steps etc. complete. | | | | | | | | |
| | Flooring Godown | 1 | 15.40 | 9.20 | | 141.68 | | | |
| | | | | | | 141.68 | Sqm | 359.10 | 50877.00 |
| 25 | [S.O.R.P/249 & I/13.46.1] | | | | | | | | |
| | Applying one coat of water thinnable cement primer of approved brand and manufacture on wall surface. | | | | | | | | |
| | 2x2 | 4 | 8.80 | 4.30 | | 151.36 | | | |
| | 2x1 | 2 | 16.00 | 4.30 | | 137.60 | | | |
| | Ceiling | 1 | 16.00 | 8.80 | | 140.80 | | | |
| | | 1 | 16.00 | 4.30 | | 68.80 | | | |
| | | 1 | 16.00 | 3.30 | | 52.80 | | | |
| | 2x2 | 4 | 3.00 | 3.30 | | 39.60 | | | |
| | Deduction Window | -4 | 1.20 | 0.90 | | -4.32 | | | |
| | Deduction Door | -1 | 1.20 | 2.10 | | -2.52 | | | |
| | Deduction R/s | -2 | 2.40 | 2.70 | | -12.96 | | | |
| | Deduction ventilator | -8 | 1.00 | 0.50 | | -4.00 | | | |
| | Deduction Channel Gate | -1 | 3.00 | 3.00 | | -9.00 | | | |
| | First Floor Inside | 2 | 8.80 | 3.30 | | 58.08 | | | |
| | (2x2) | 4 | 4.00 | 3.30 | | 52.80 | | | |
| | | 1 | 8.80 | 4.00 | | 35.20 | | | |
| | Deduction Window | -5 | 1.20 | 0.90 | | -5.40 | | | |
| | Deduction Door (2x1) | -2 | 1.00 | 2.10 | | -4.20 | | | |
| | | | | | | 694.64 | Sqm | 21.60 | 15004.00 |
| 26 | [S.O.R.P/248 & I/13.41] | | | | | | | | |
| | P/A cement based putty of average thickness 1mm of approved brand birla white / J.K. or equivalent, over the plaster wall surface to prepare the surface even & smooth i/c all cost of materials, labours & scaffold etc complete | | | | | | | | |
| | Out Side | 1 | 16.00 | 5.65 | | 90.40 | | | |

| | | | | | | | | | |
|----|--|----|-------|------|------|---------|-----|-------|----------|
| | | 2 | 9.20 | 5.65 | | 103.96 | | | |
| | | 1 | 16.00 | 1.00 | | 16.00 | | | |
| | | 2 | 3.00 | 4.65 | | 27.90 | | | |
| | | 1 | 16.00 | 4.65 | | 74.40 | | | |
| | Deduction Window | -3 | 1.20 | 0.90 | | -3.24 | | | |
| | Deduction Channel Gate | -1 | 3.00 | 3.00 | | -9.00 | | | |
| | Deduction Ventilator | -8 | 1.00 | 0.50 | | -4.00 | | | |
| | Inside (2x2) | 4 | 8.80 | 4.30 | | 151.36 | | | |
| | (2x1) | 2 | 16.00 | 4.30 | | 137.60 | | | |
| | Ceiling | 1 | 16.00 | 8.80 | | 140.80 | | | |
| | | 1 | 16.00 | 4.30 | | 68.80 | | | |
| | | 1 | 16.00 | 3.30 | | 52.80 | | | |
| | Deduction Window | -4 | 1.20 | 0.90 | | -4.32 | | | |
| | Deduction Door | -1 | 1.20 | 2.10 | | -2.52 | | | |
| | Deduction R/s | -2 | 2.40 | 2.70 | | -12.96 | | | |
| | Deduction Ventilator | -8 | 1.00 | 0.50 | | -4.00 | | | |
| | Deduction Channel Gate | -1 | 3.00 | 3.00 | | -9.00 | | | |
| | Inside | 2 | 8.80 | 3.30 | | 58.08 | | | |
| | (2x2) | 4 | 4.00 | 3.30 | | 52.80 | | | |
| | Col | 1 | 8.80 | 4.00 | | 35.20 | | | |
| | Deduction Window | -5 | 1.20 | 0.90 | | -5.40 | | | |
| | Deduction Door (2x1) | -2 | 1.00 | 2.10 | | -4.20 | | | |
| | Out Side | 2 | 9.20 | 3.45 | | 63.48 | | | |
| | | 2 | 4.30 | 3.45 | | 29.67 | | | |
| | | 1 | 9.20 | 1.00 | | 9.20 | | | |
| | | | | | | 1053.81 | Sqm | 66.60 | 70183.00 |
| 27 | [S.O.R.P/250 & I/13.55.1] | | | | | | | | |
| | Finishing walls with Acrylic Smooth exterior paint of required shade:New work (Two or more coat applied @ 1.67 ltr/10 sqm over and including priming coat of exterior primer applied @ 2.20 Kg/ 10 sqm). | | | | | | | | |
| | Out Side | 1 | 16.00 | 5.65 | | 90.40 | | | |
| | | 2 | 9.20 | 5.65 | | 103.96 | | | |
| | | 1 | 16.00 | 1.00 | | 16.00 | | | |
| | | 2 | 3.00 | 4.65 | | 27.90 | | | |
| | | 1 | 16.00 | 4.65 | | 74.40 | | | |
| | Deduction Window | -3 | 1.20 | 0.90 | | -3.24 | | | |
| | Deduction Channel Gate | -1 | 3.00 | 3.00 | | -9.00 | | | |
| | Deduction Ventilator | -8 | 1.00 | 0.50 | | -4.00 | | | |
| | Out Side | 2 | 9.20 | 3.45 | | 63.48 | | | |
| | | 2 | 4.30 | 3.45 | | 29.67 | | | |
| | | 1 | 9.20 | 1.00 | | 9.20 | | | |
| | Deduction Window | -5 | 1.20 | 0.90 | | -5.40 | | | |
| | Deduction door | -1 | 1.00 | 2.10 | | -2.10 | | | |
| | | | | | | 391.27 | Sqm | 78.30 | 30636.00 |
| 28 | [S.O.R.P/252 & I/13.68.1] | | | | | | | | |
| | Painting with synthetic enamel paint of approved brand and manufacture to give an even shade :Two or more coats on new work | | | | | | | | |
| | Channel Gate (1x2) | 2 | 2.00 | 3.00 | 3.00 | 36.00 | | | |
| | Window | 4 | 2.00 | 1.20 | 0.90 | 8.64 | | | |
| | Door | 1 | 2.00 | 1.20 | 2.10 | 5.04 | | | |
| | Rolling Shutter (2x2) | 4 | 1.25 | 2.40 | 2.70 | 32.40 | | | |
| | Ventilator | 8 | 2.00 | 1.00 | 0.50 | 8.00 | | | |
| | Window | 5 | 2.00 | 1.20 | 0.90 | 10.80 | | | |
| | | 2 | 2.00 | 1.00 | 2.10 | 8.40 | | | |
| | | | | | | 109.28 | Sqm | 47.70 | 5212.00 |

| | | | | | | | | | |
|----|---|----|-------|-------|------|--------|-----|--------|----------|
| 29 | SOR 4.12/47 | | | | | | | | |
| | Extra for providing and mixing water proofing material as per IS standard in cement concrete work quantity as prescribed by the manufacturer | | | | | | | | |
| | (8.02+23.05+5.99)=37.06 | | 37.06 | 8.20 | | 303.00 | Cum | 39.60 | 11999.00 |
| 30 | SOR 13.27/247 | | | | | | | | |
| | Providing & fixing chicken mesh as per ISI specification and in the required with 50mm long Bombay nails on vertical and horizontal junctions of RCC and brick wall including scaffolding and all lead and lift etc. complete before plastering up to 10 meter height | | | | | | | | |
| | COLUMNS VERTICAL UP TO 2.10 | 13 | 2.00 | 0.60 | 4.30 | 67.08 | | | |
| | COLUMNS VERTICAL ABOVE 2.30 | 2 | 4.00 | 16.00 | 0.60 | 76.80 | | | |
| | COLUMNS VERTICAL ABOVE ROOF | 2 | 4.00 | 12.40 | 0.60 | 59.52 | | | |
| | | | | | | 203.40 | Sqm | 55.80 | 11350.00 |
| 31 | SOR 13.6/244 | | | | | | | | |
| | 18 mm cement plaster in two coats under layer 12 mm thick cement plaster 1:5 (1 cement : 5 sand) finished with a top layer 6mm thick cement plaster 1:4 (1 cement : 4 sand) | | | | | | | | |
| | OUTSIDE | | | | | | | | |
| | FRONT | 2 | 16.00 | 4.90 | | 156.80 | | | |
| | RHS | 2 | 12.40 | 4.90 | | 121.52 | | | |
| | | | | | | 278.32 | Sqm | 153.90 | 42833.00 |
| 32 | SOR 12.26.1 /222 | | | | | | | | |
| | Providing gola 75x75 mm in cement concrete 1:2:4 (1 cement : 2 sand : 4 stone aggregate 10mm and down graded) including finishing with cement mortar 1:3 (1 Cement : 3 fine sand) as per standard design: In 75x75mm deep chase | | | | | | | | |
| | PARAPET | 2 | 16.00 | | | 32.00 | | | |
| | | 2 | 12.40 | | | 24.80 | | | |
| | columns | 3 | 1.20 | | | 3.60 | | | |
| | chhajja | 3 | 1.50 | | | 4.50 | | | |
| | | | | | | 64.90 | Rmt | 89.10 | 5,783.00 |
| 33 | SOR 5.24/69 | | | | | | | | |
| | Providing for plaster drip course/ groove in plastered surface or moulding to R.C.C. Projections | | | | | | | | |
| | WALL V | 13 | 2.00 | 4.60 | | 119.60 | | | |
| | | 13 | 2.00 | 0.60 | | 15.60 | | | |
| | | 2 | 4.00 | 16.00 | | 128.00 | | | |
| | F & B H | 2 | 4.00 | 12.40 | | 99.20 | | | |
| | chhajja | 3 | 1.00 | 1.50 | | 4.50 | | | |
| | | 3 | 2.00 | 0.45 | | 2.70 | | | |
| | | | | | | 369.60 | Rmt | 16.65 | 6154.00 |
| 34 | SOR 11.88.1/212 AMMENDMENT | | | | | | | | |
| | Providing and laying vitrified floor tiles in different sizes with water absorption's less than 0.05% and conforming to IS : 15622 of approved make in all colours and shades, 1st quality premium in flooring laid on 20mm thick cement mortar 1:4 (1 cement : 4 sand) including grouting the joints with white cement and matching pigments etc., complete. Size of Tile 600x600x 9-10 mm | | | | | | | | |
| | INSIDE | | | | | | | | |
| | HALL | 1 | 4.00 | 3.00 | | 12.00 | | | |

| | | | | | | | | | |
|----|--|---|-------|------|-------|-------|-----|--------|----------|
| | ROOM | 1 | 4.00 | 8.80 | | 35.20 | | | |
| | SKIRTING | 2 | 4.00 | 0.10 | | 0.80 | | | |
| | | 2 | 8.80 | 0.10 | | 1.76 | | | |
| | ROOM | 2 | 4.00 | 0.10 | | 0.80 | | | |
| | | 2 | 3.00 | 0.10 | | 0.60 | | | |
| | | | | | | 51.16 | Sqm | 765.00 | 39137.00 |
| 35 | SOR 10.17/181 | | | | | | | | |
| | Providing and fixing circular/ Hexagonal cast iron or M.S. sheet box for ceiling fan clamp of internal dia 140mm, 73mm height, top lid of 1.5mm thick M.S. sheet with its top surface hacked for proper bonding, top lid shall be screwed into the cast iron/ M.S. sheet box by means of 3.3mm dia. round headed screws, one lock at the corners. Clamp shall be made of 16mm dia M.S. bar bent to shape as per standard | | | | | | | | |
| | | | | | | 5.00 | Nos | 133.56 | 668.00 |
| 36 | SOR 11.34.1 amd. 12.07.2016 | | | | | | | | |
| | Kota stone slabs 20 mm thick in risers of steps, skirting, dado and pillars laid on 12 mm (average) thick cement mortar 1:3 (1 cement 3 sand) and jointed with grey cement slurry mixed with pigment to match the shade of the slabs, including rubbing and polishing complete. | | | | | | | | |
| | | 1 | 1.00 | 3.00 | 13.00 | 39.00 | | | |
| | | 1 | 26.00 | 1.20 | 0.30 | 9.36 | | | |
| | | 1 | 26.00 | 1.20 | 0.15 | 4.68 | | | |
| | | | | | | 53.04 | Sqm | 688.50 | 36518.00 |
| 37 | SOR 11.46 Amd 12.07.2016 | | | | | | | | |
| | Providing and laying Glazed Ceramic floor tiles 300x300 mm or more (having thickness 9 to 10mm) of 1st quality conforming to IS : 15622 of approved make in colours White, Ivory, Grey, Fume Red Brown, laid on 20mm thick cement mortar 1:4 (1 Cement : 4 sand) including grouting the joints with white cement and matching pigments etc., | | | | | | | | |
| | | 1 | 1.80 | 1.20 | | 2.16 | | | |
| | | | | | | 2.16 | Sqm | 644.40 | 1392.00 |
| 38 | SOR 11.47 amd 12.07.2016 | | | | | | | | |
| | Providing and laying Glazed Ceramic wall tiles 300x450 mm or more (thickness to be specified by the manufacturer) of 1st quality conforming to IS : 15622 of approved make in colours White, Ivory, Grey, Fume Red Brown, laid on 12 mm thick cement mortar 1:3 (1 Cement : 3 sand) including grouting the joints with white cement and matching pigments | | | | | | | | |
| | | 2 | 1.80 | 2.10 | | 7.56 | | | |
| | | 2 | 1.20 | 2.10 | | 5.04 | | | |
| | | | | | | 12.60 | Sqm | 558.00 | 7031.00 |

| | | | | | | | | | |
|----|---|---|-------|------|-------|--------|-----|--------|----------|
| 39 | SOR21.1.1.2/362 | | | | | | | | |
| | Providing and fixing aluminium work for doors, windows, ventilators and partitions with extruded built up standard tubular sections/ appropriate Z sections and other sections of approved make conforming to IS: 733 and IS: 1285, fixing with dash fasteners of required dia and size, including necessary filling up the gaps at junctions, i.e. at top, bottom and sides with required EPDM rubber/ neoprene gasket etc. Aluminium sections shall be smooth, rust free, straight, mitred and jointed mechanically wherever required including cleat angle, Aluminium snap beading for glazing / paneling, C.P. brass / stainless steel screws, all complete as per architectural drawings and the directions of Engineer-in-charge. (Glazing, paneling and dash fasteners to be paid for separately) For shutters of doors, windows and ventilators including providing and fixing hinges/ pivots and making provision for fixing of fittings wherever required including the cost of EPDM rubber / neoprene gasket required (Fittings shall be paid for separately). For fix portion Powder Coated Aluminium (Minimum thickness of Powder Coating 50 Micron) | | | | | | | | |
| | FRAME BOTTAM | 4 | 1.20 | 0.90 | 13.80 | 59.62 | | | |
| | | | | | | 59.62 | Kg | 339.30 | 20229.00 |
| 40 | SOR 21.3.1/363 | | | | | | | | |
| | Providing and fixing glazing in aluminium door, window, ventilator shutters and partitions etc. with EPDM rubber/ neoprene gasket etc. complete as per the architectural drawings and the directions of engineer-in-charge . (Cost of aluminium snap beading shall be paid in basic item) : | | | | | | | | |
| | WINDOW | 4 | 1.20 | 0.90 | | 4.32 | | | |
| | | | | | | 4.32 | Sqm | 764.10 | 3301.00 |
| 41 | SOR 11.1.1 /196 | | | | | | | | |
| | Cement concrete flooring 1:2:4 (1 cement : 2 sand : 4 graded stone aggregate) finished with a floating coat of neat cement including cement slurry, but excluding the cost of nosing of steps etc. Complete.(Area of panel not to exceed 2.0 sqm) 40mm thick with 20mm nominal size stone aggregate. | | | | | | | | |
| | | 1 | 13.00 | 8.80 | | 114.40 | | | |
| | | 1 | 13.00 | 3.00 | | 39.00 | | | |
| | | | | | | 153.40 | Sqm | 243.00 | 37276.00 |
| 42 | SOR 09.65.2/142 | | | | | | | | |
| | Providing and fixing ISI marked stainless steel sliding door bolts with nuts and screws etc. complete : :250x16 mm | | | | | | | | |
| | :250x16 mm | | | | | 3.00 | Nos | 293.40 | 880.00 |
| 43 | SOR 09.65.1/142 | | | | | | | | |
| | Providing and fixing ISI marked stainless steel sliding door bolts with nuts and screws etc. complete : | | | | | | | | |
| | :300x16 mm | | | | | 3.00 | Nos | 350.10 | 1,050.00 |

| | | | | | | | | | |
|---|---|---|-------|-------|--|--------|-----|--------|-------------------|
| 44 | SOR 09.66.3/142 | | | | | | | | |
| | Providing and fixing ISI marked stainless steel tower bolt black finish, (Barrel type) with necessary screws etc. complete | | | | | | | | |
| | 150x10 mm | | | | | 3.00 | Nos | 63.90 | 192.00 |
| 45 | SOR 09.69.2/143 | | | | | | | | |
| | Providing and fixing ISI marked stainless steel handles with necessary screws etc. complete ::125 mm | | | | | | | | |
| | 125 mm | | | | | 6.00 | Nos | 48.60 | 292.00 |
| 46 | SOR 09.114.1/149 | | | | | | | | |
| | Providing and fixing aluminium hanging floor door stopper ISI marked anodised (anodic coating not less than grade AC 10 as per IS : 1868) transparent or dyed to required colour and shade with necessary screws etc. complete. | | | | | | | | |
| | Single rubber stopper | | | | | 3.00 | Nos | 31.50 | 95.00 |
| 47 | SOR 09.62.1/143 | | | | | | | | |
| | Providing and fixing oxidised M.S. hasp and staple (safety type) conforming to IS : 363 with necessary screws etc. complete : | | | | | | | | |
| | 150 mm | | | | | 7.00 | Nos | 20.70 | 145.00 |
| 48 | [S.O.R.P/28 & I/2.32] | | | | | | | | |
| | Preconstruction antitermite treatment to the building under construction by providing Stage 1: Treating the bottom and the sides (upto 30cm high of the excavated trench @ 5 litter per sqm of the surface area.Stage 2: After masonry/RCC work, the backfill in the immdiate contact with the foundation structure treatment @ 7.5 litter per sqm. of the vertical surface of the substructure for each side. Stage 3: surface treatment by spreading emulsion over the plinth area before laying the base concrete under floors @ 5.0 litres/Sqm. Stage 4: Pumping the emulsion in plinth masonry on filling side at floor junction @ 7.5 litres/Sqm. Stage 5: Pumping the emulsion from outer side of the plinth below ground around the masonry @ 5.0 litres/Sqm as per I.S. 8944 Emulsion. (1Chlorpyrifos: 19 water) with five years service guarantee (Measurements to be taken for plinth area) Note – Treatment should start when foundation trenches and pits are ready to take bed concrete or leveling course in foundations. Laying of bed concrete should start when the chemical emulsion has been absorbed by the soil and the surface is reasonably dry. Treatment should not be carried out when it is raining or when soil is wet with rain or subsoil water. This also applies to filled up soil within the plinth area before laying the subgrade for flooring. | | | | | | | | |
| | | 1 | 16.30 | 12.80 | | 208.64 | | | |
| | | | | | | 208.64 | Sqm | 118.80 | 24786.00 |
| Total:- | | | | | | | | | 3026744.00 |
| Add :- Sanitary work & Septic Tank Etc.@ 7.0 % | | | | | | | | | 211872.00 |
| Add :- Electification Charges @ 3.5 % | | | | | | | | | 105936.04 |
| G.Total:- | | | | | | | | | 3344552.04 |

(Sub Engineer)

(Assistant Engineer)

(Executive Engineer)

Signature Not Verified

Digitally signed by Sandhya Sagar Sikarwar
Date: 2023.04.23 12:59:24 IST
Location: Madhya Pradesh-MP

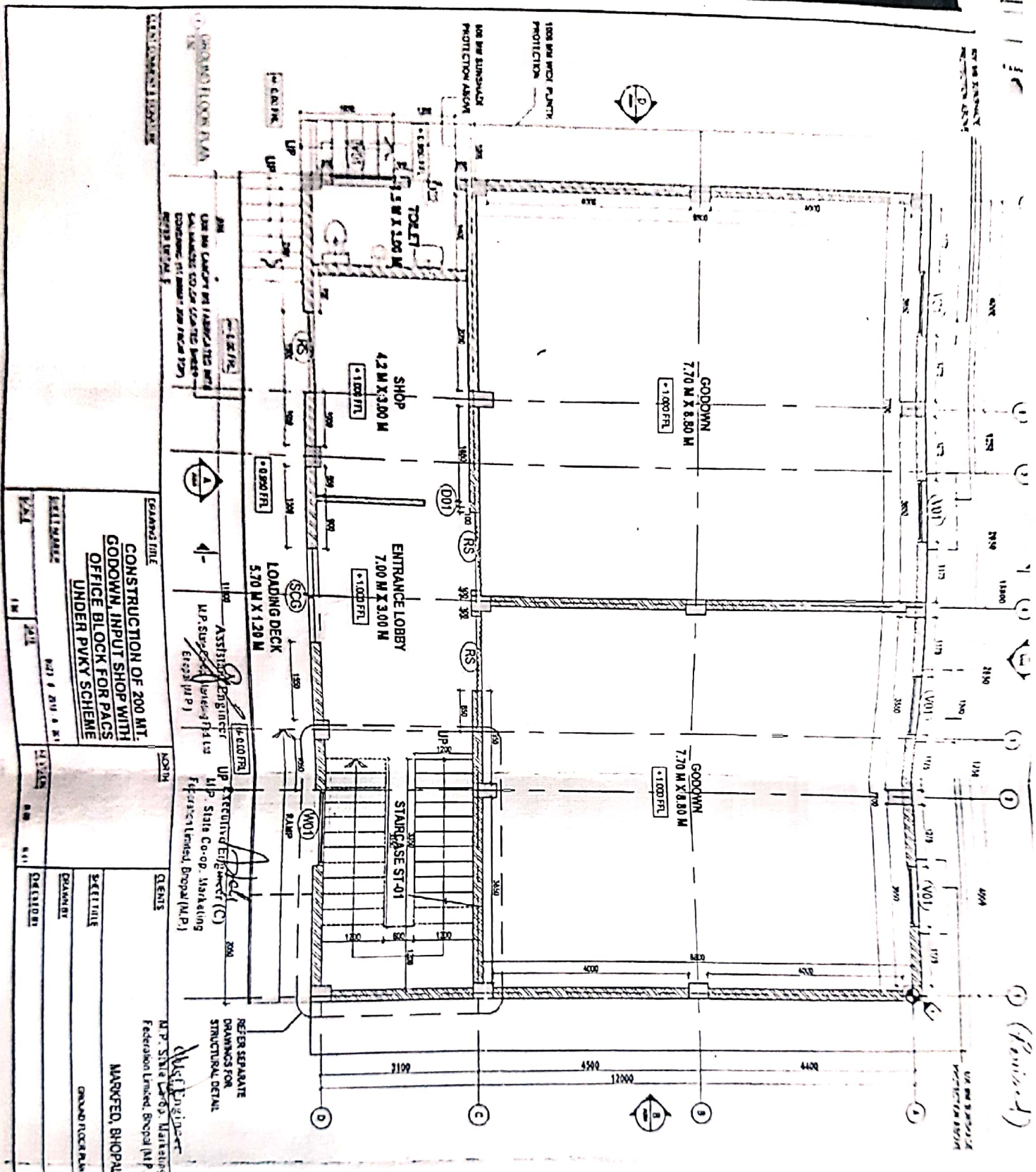

Expanded Title
CONSTRUCTION OF 200 MT GODOWN, INPUT SHOP WITH OFFICE BLOCK FOR PAGES UNDER PVKY SCHEME

DATE 10/11/2011
SCALE 1/40

CLIENTS
 M.P. State Co-op. Marketing Federation Limited, Bhopal (M.P.)

DESIGNER
 K.S. ARCHITECTURAL CONSULTANTS

CLIENTS
 M.P. State Co-op. Marketing Federation Limited, Bhopal (M.P.)

DESIGNER
 K.S. ARCHITECTURAL CONSULTANTS

K.S. ARCHITECTURAL CONSULTANTS

ARCHITECTURAL CONSULTANTS

PROJECT OBJECTIVE
K.S. ARCHITECTURAL CONSULTANTS

CONTACT INFORMATION
 Email: kshree@architects@gmail.com
 Website: www.architects.in
 Phone No: 4314430, 4314393, 995205339

LEGEND

1. COORDINATES FOR PLACEMENT OF COLUMN CAP

2. FINISHED FLOOR LEVEL

3. FINISHED FLOOR LEVEL

4. TOP OF CONCRETE

5. STEEL COLUMN/BEAM/RAILING CLARE

6. ROLLING SHUTTER CLARE

DRINKING WATER

| NO | TYPE | DIAMETER | DEPTH | LOCATION | REMARKS |
|----|-------|----------|-------|----------|---------|
| 1 | WATER | 150 | 10 | ... | ... |
| 2 | WATER | 150 | 10 | ... | ... |
| 3 | WATER | 150 | 10 | ... | ... |
| 4 | WATER | 150 | 10 | ... | ... |
| 5 | WATER | 150 | 10 | ... | ... |
| 6 | WATER | 150 | 10 | ... | ... |
| 7 | WATER | 150 | 10 | ... | ... |
| 8 | WATER | 150 | 10 | ... | ... |
| 9 | WATER | 150 | 10 | ... | ... |
| 10 | WATER | 150 | 10 | ... | ... |

1. THE WORK IS TO BE DONE IN ACCORDANCE WITH THE SPECIFICATIONS AND DRAWINGS PROVIDED.

2. THE CONTRACTOR SHALL BE RESPONSIBLE FOR OBTAINING ALL NECESSARY PERMITS AND APPROVALS FROM THE LOCAL AUTHORITIES.

3. THE CONTRACTOR SHALL MAINTAIN ACCESS TO ALL ADJACENT PROPERTIES AT ALL TIMES.

4. THE CONTRACTOR SHALL BE RESPONSIBLE FOR THE PROTECTION OF ALL EXISTING UTILITIES AND STRUCTURES.

5. THE CONTRACTOR SHALL MAINTAIN A SAFE WORKING ENVIRONMENT AT ALL TIMES.

6. THE CONTRACTOR SHALL BE RESPONSIBLE FOR THE DISPOSAL OF ALL WASTE MATERIALS.

7. THE CONTRACTOR SHALL BE RESPONSIBLE FOR THE PROTECTION OF ALL ADJACENT PROPERTIES.

8. THE CONTRACTOR SHALL BE RESPONSIBLE FOR THE PROTECTION OF ALL EXISTING UTILITIES AND STRUCTURES.

9. THE CONTRACTOR SHALL MAINTAIN A SAFE WORKING ENVIRONMENT AT ALL TIMES.

10. THE CONTRACTOR SHALL BE RESPONSIBLE FOR THE DISPOSAL OF ALL WASTE MATERIALS.

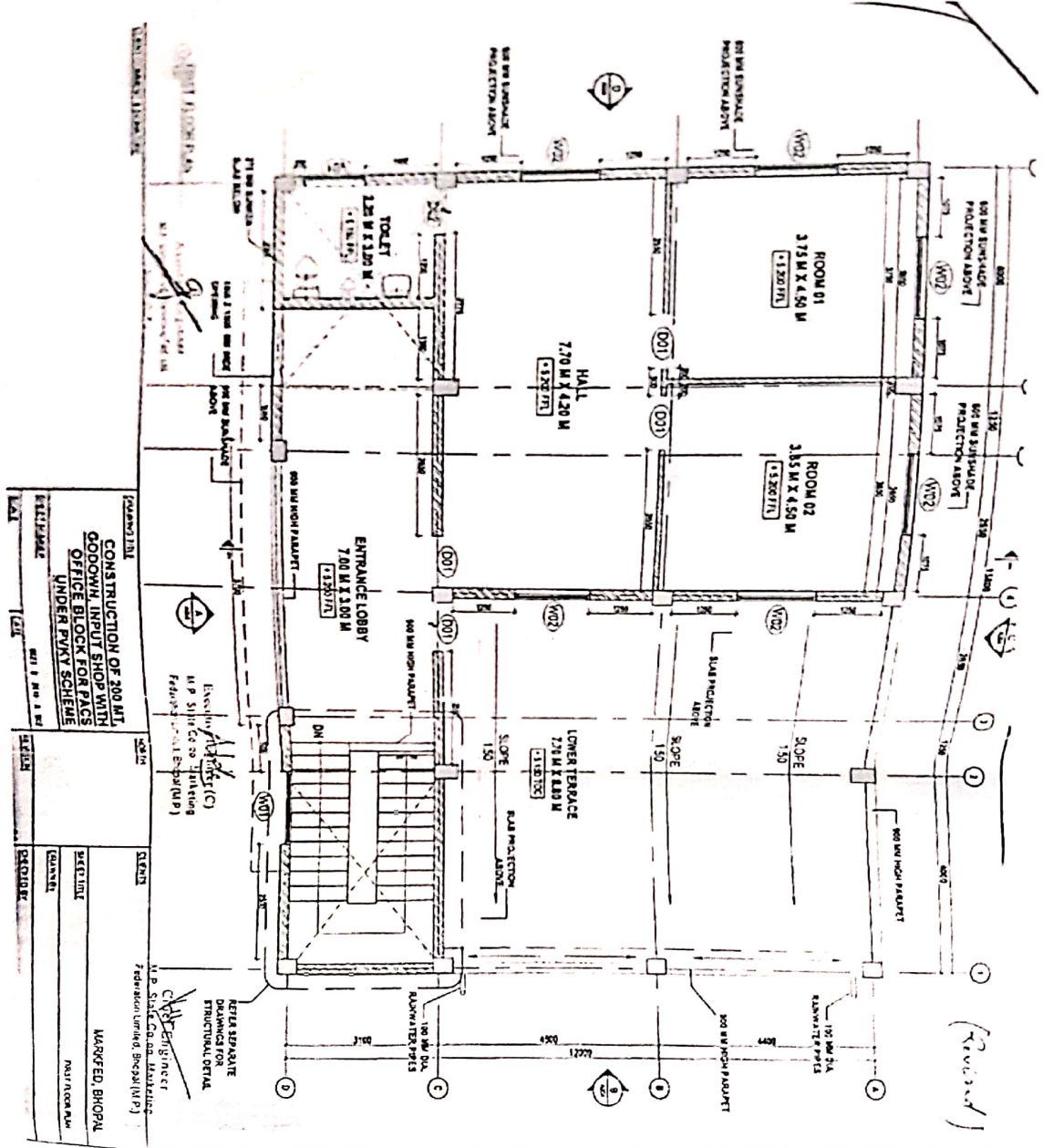

PROJECT INT.
 CONSTRUCTION OF 200 MT.
 CONDO/INP INPUT SHOP WITH
 OFFICE BLOCK FOR PAGES
 UNDER PAKY SCHEME

DRAWING NO. 1/21
 DATE 12/11/11
 SHEET NO. 1/1

CLIENT: M.P. STATE CO. AND MASTERS
 ARCHITECT: K.S. INSIGHT ARCHITECTURAL CONSULTANTS
 ENGINEER: M.P. STATE CO. AND MASTERS

K.S. INSIGHT ARCHITECTURAL
 CONSULTANTS
 Email: kshin@ksa.com
 Website: www.ksa.com
 Phone No: 91-98200-00000

K.S. INSIGHT ARCHITECTURAL CONSULTANTS
 ARCHITECT
 PROJECTOR

LEGEND
 (1) CONSTRUCTION MURCH VET. DA. W.P.P.
 (2) FIN. FLOOR/ROOF/CL. LVL.
 (3) FIN. FLOOR/ROOF/CL. LVL.
 (4) FIN. FLOOR/ROOF/CL. LVL.

| NO. | TYPE | DESCRIPTION | DATE | BY | CHKD. |
|-----|------|------------------------------------|----------|----|-------|
| 1 | 1/1 | CONSTRUCTION MURCH VET. DA. W.P.P. | 12/11/11 | | |
| 2 | 1/1 | FIN. FLOOR/ROOF/CL. LVL. | 12/11/11 | | |
| 3 | 1/1 | FIN. FLOOR/ROOF/CL. LVL. | 12/11/11 | | |
| 4 | 1/1 | FIN. FLOOR/ROOF/CL. LVL. | 12/11/11 | | |