

NOTES :-

1. TYPE OF BRIDGE
2. LENGTH OF BRIDGE
3. OVER ALL WIDTH
4. CLEAR CARRIAGE WAY
5. FORMATION LEVEL
6. L.W.L.
7. H.F.L. / O.F.L.
8. B.B.C.
9. CAUTEMENT AREA
10. DESIGN DISCHARGE
11. DESIGN VELOCITY
12. TYPE OF FOUNDATION
13. TYPE OF SUB-STRUCTURE
14. BOX UNITS
15. FOUNDATION LEVEL / STRATA
16. ABUTMENT
17. CUTOFF WALL
18. RAILING
19. WEARING COAT
20. EXPANSION JOINTS
21. SPECIFICATIONS
22. DESIGN LOADS
23. SEISMIC ZONE & IMPORTANCE FACTOR
24. DIMENSIONS OF DIFFERENT ELEMENTS AND FOUNDATION LEVELS ETC. INDICATED IN THIS DRAWING ARE TENTATIVE AND FOR ESTIMATE PURPOSE ONLY. THIS MAY VARY AFTER DETAILED INVESTIGATION / DESIGN.

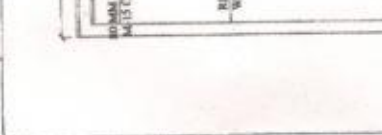
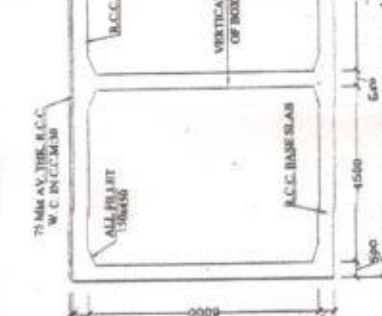
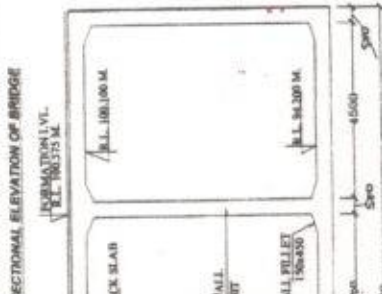

CHECKED BY	CHECKED BY	CHECKED BY	APPROVED BY
[Signature]	[Signature]	[Signature]	[Signature]
A.E. (U)	E.E. (D)	S.E. (D)	C.E.
DESIGN			
PROJECT	P.S.D. BRIDGE CONSTRUCTION ZONE HOSPITAL		
	CONSTRUCTION OF BOX TYPE SUBMISSIBLE UNDER JAMPAD KAREL BRIDGE ACROSS BARBERWA RIVER ON DEVAKACHHAR TO RATIKAR ROAD IN DISTT. MADHOPUR		
FILE	GENERAL ARRANGEMENT DRAWING		
DATE	24-10-2022 DNG NO. - C-37PK - 298		

21. Work done

100 MM FLEXIBLE BOLLER APRON
150 MM C.C. M-15
300 MM BOLLERS PACKED WITH CRUSHED METAL
R.C.C. CHUTE WALL WITH 300 MM HEIGHT 300 MM

150 MM DIA. A.C. PRESSURE RELIEF PIPES IN EACH BOX
R.C.C. BOTTOM SLAB OF BOX UNIT 300 MM THICK
150 MM FLEXIBLE BOLLER APRON
300 MM BOLLERS PACKED WITH CRUSHED METAL
150 MM THICK LEVELLING COURSE M-15

150 MM THICK LEVELLING COURSE IN M-15 C.C.

CROSS SECTION OF APRON

Executive Engineer
P.W.D. Bridge Construction
Division, Jabalpur

Handwritten signature and initials.